

Staircase A1 - Staircase next to Dental Clinic

Staircase A2 - Staircase next to HOD Room

Staircase B3 - Staircase next to Media Resource Room

Staircase C4 - Old Cow Staircase / Staircase next to new Science Lab

Staircase D6 - Criss-Cross Staircase (2 sets, one from the chest corner, one nearer canteen)

Staircase E7 - Staircase behind canteen leading up to the Buddha Statue

Staircase E8 - Staircase next to Old Bookshop (Only accesses Level 2)

Staircase F1 - Staircase at Blk F next to Sheltered Linkway

Staircase F2 - Staircase next to lift in Blk F

Staircase G1 - Staircase next to lift at ISH (Accesses up to Level 4)

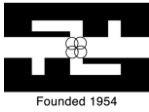

Overview of School Seating Plan

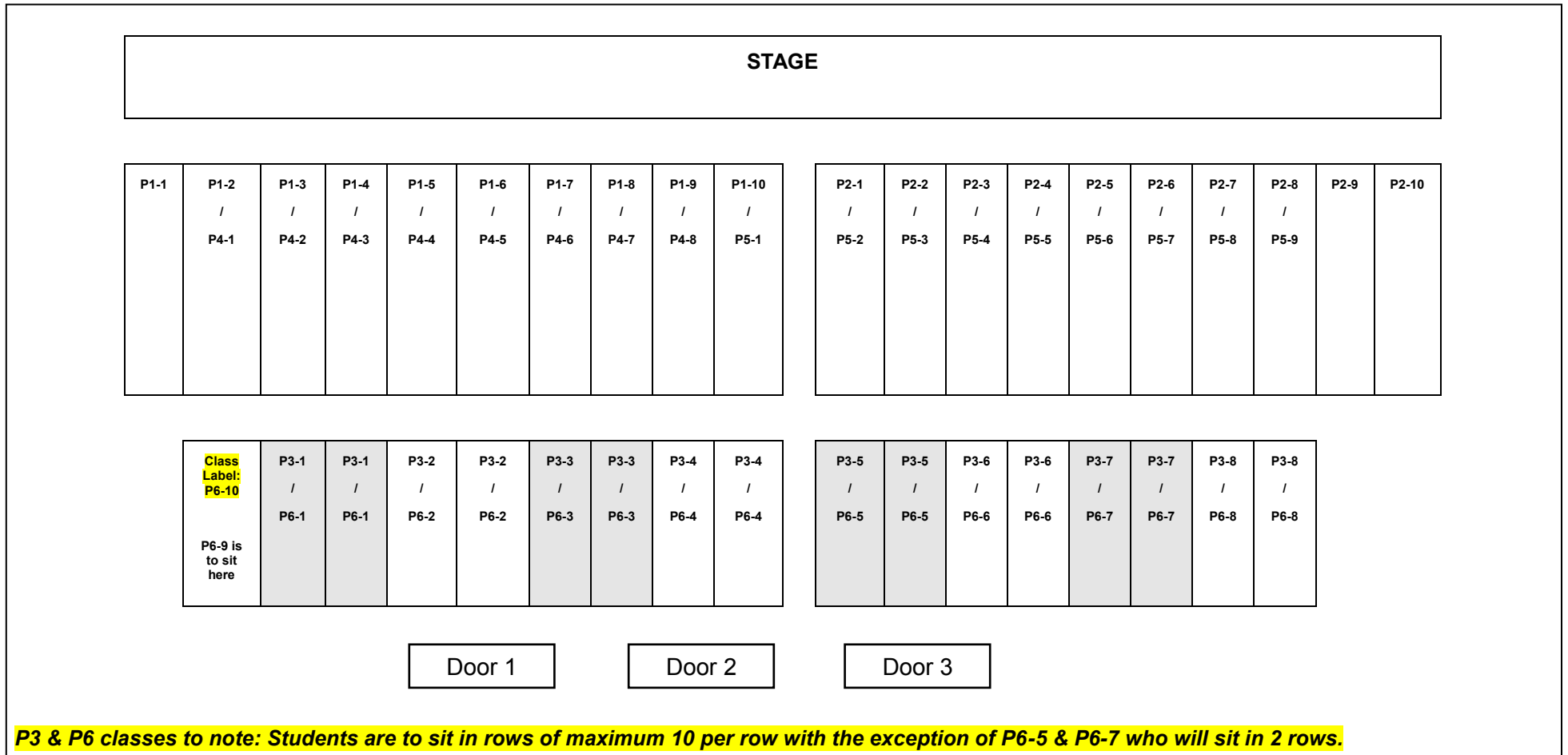

Overview of Movement Plan from Multi-Purpose Hall to Classrooms:

Primary 1 to Primary 3

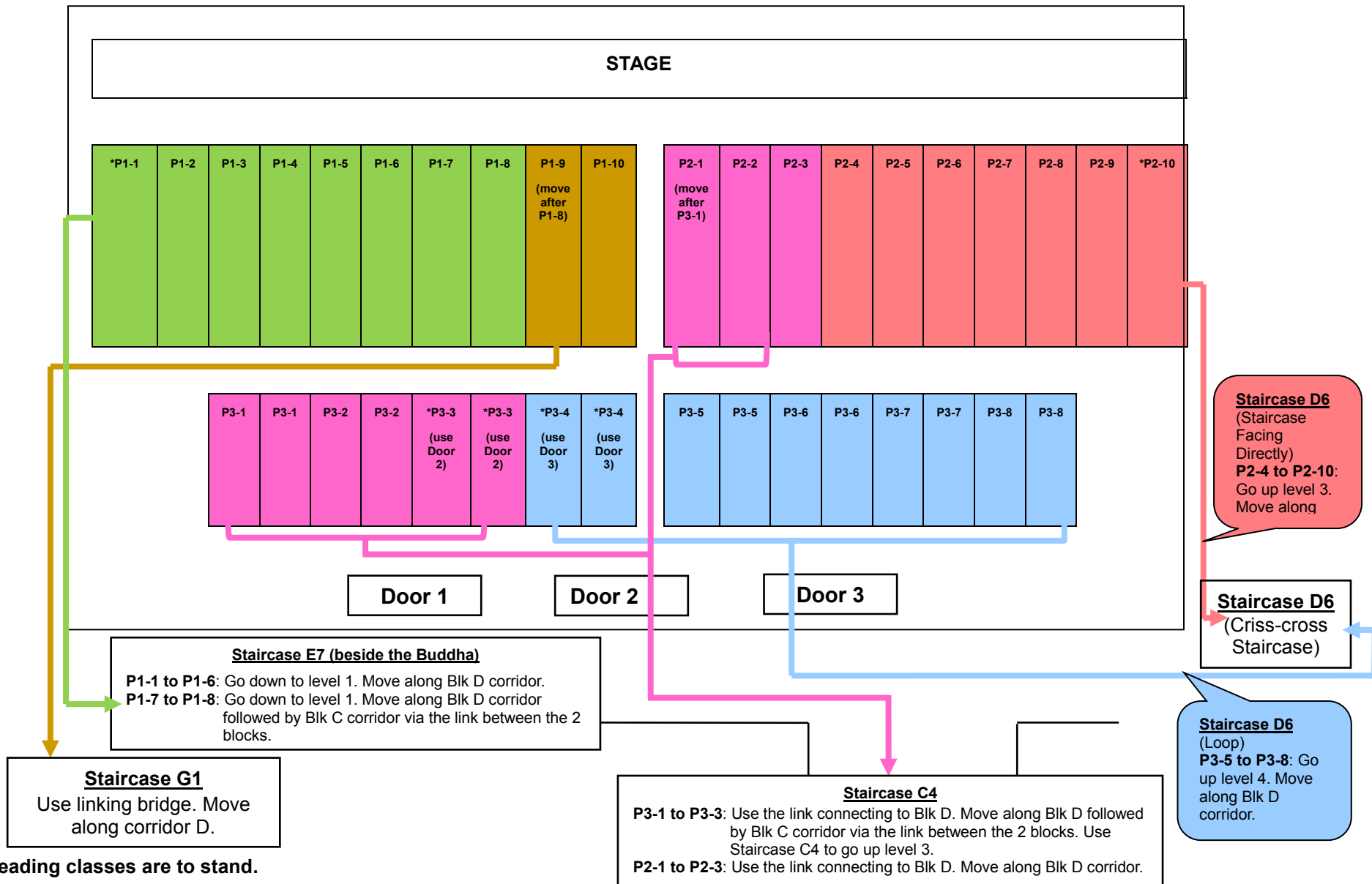

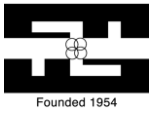

Overview of Movement Plan from Multi-Purpose Hall to Classrooms:

Primary 4 to Primary 6

Staircase E8:
Use Staircase E8 to go level 1. Move across the parade square towards the library to go Blk F. Use Staircase F2 to go level 2.

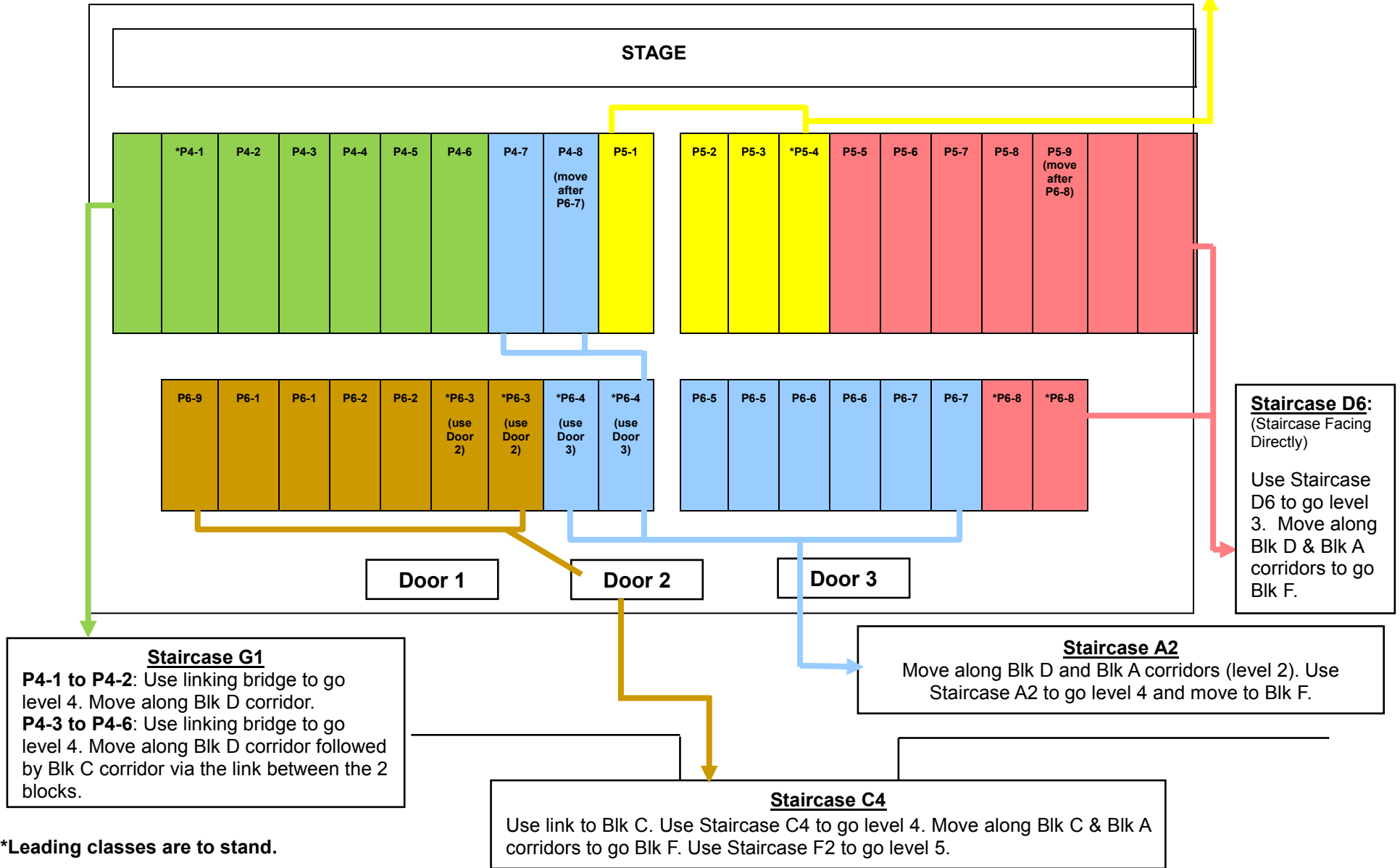

*Leading classes are to stand.