

Staircase G2

P1-1 to P1-6: Go down to level 1. Move along Blk G (Level 1 ISH) followed by Blk D corridor.

P1-7 to P1-8: Go down to level 1. Move along Blk G (Level 1 ISH) followed by Blk D corridor. Turn right to Blk C corridor via the link between Blk D & C.

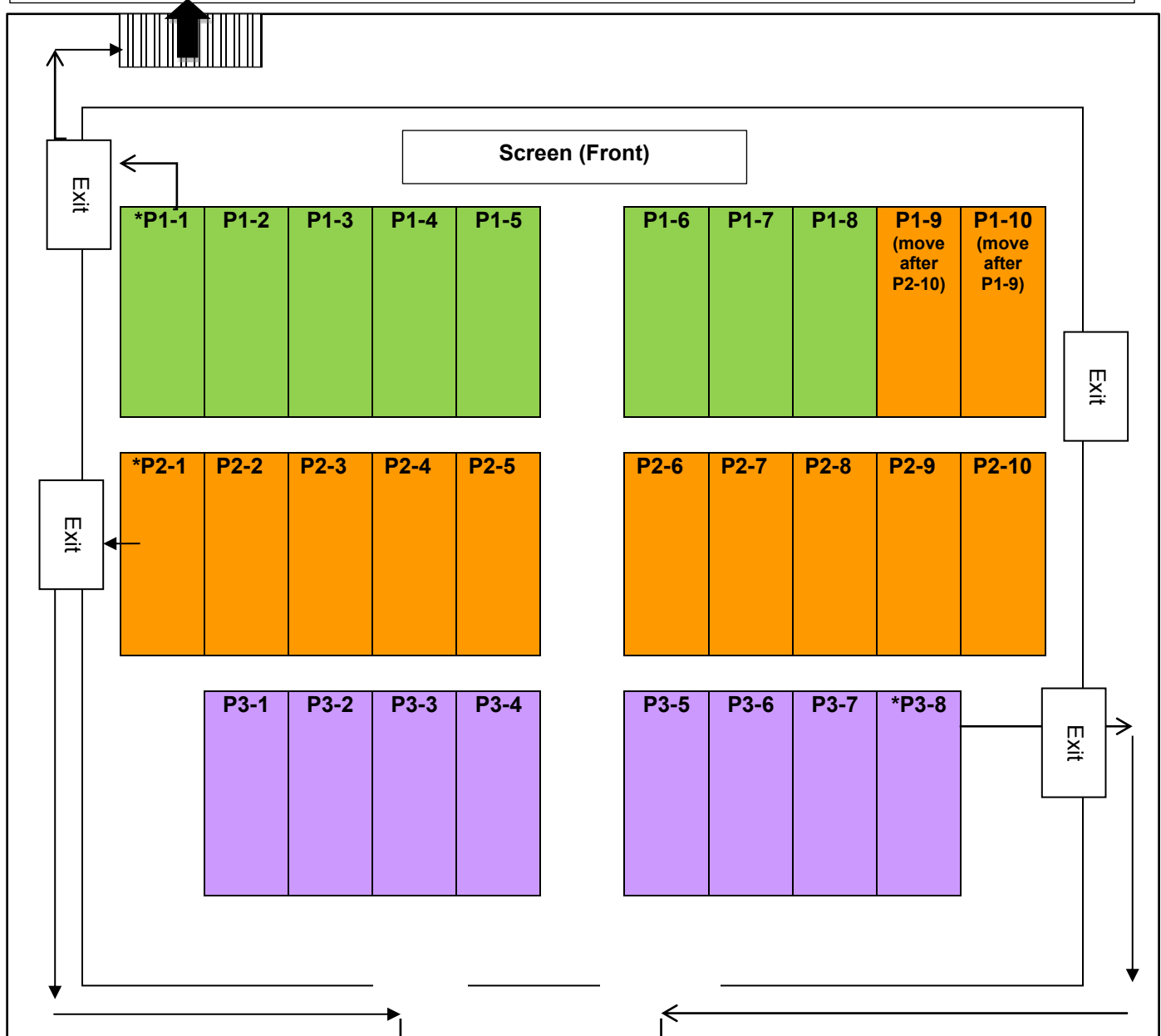

Staircase G1

P2-1 to P2-3:
Go down to level 2. Move along Blk D corridor followed by Blk C corridor via the link between the 2 blocks.

P2-4 to P2-10:
Go down to level 3. Move along Blk D corridor.

P1-9 to P1-10:
Go down to level 2. Move along Blk D corridor.

Link Connecting to Blk D

P3-4 to P3-8:
Use the link connecting to Blk D. Move along Blk D corridor.

P3-1 to P3-3:
Use the link connecting to Blk D. Move along Blk D corridor followed by Blk C corridor via the link between the 2 blocks. Use Staircase C4 to go down level 3.

***Leading classes will stand first.**